



**ehB**  
RESIDENTIAL

Your Property - Our Business

**24 Wallace House, Lammas Walk, Warwick**

**Price Guide  
£155,000**





This spacious, one-bedroom top-floor apartment offers views over the racecourse. Ideally located close to local amenities, the town centre and accessible to road and rail commuter networks. NO UPWARD CHAIN. Energy rating C.

#### Location

Wallace House is ideally placed close to the historic county town centre and its amenities, and is easily accessible to the A46, junction 15 of the M40 motorway, and Warwick and Parkway rail stations, all providing excellent commuter links. Considered an ideal investment property, it is being sold with the benefit of no onward chain.

#### Communal Entrance Hall

Secure communal entrance hall with staircase leading to the Second Floor Landing.

#### Hallway

Storage cupboards, wall-mounted entry phone and doors to:

#### Sitting/Dining Room

17'7" x 9'6" (5.36m x 2.92m)  
wall-mounted storage heater, double-glazed bay windows with views to the rear aspect and Warwick Racecourse. Archway to:

#### Fitted Kitchen

8'9" x 6'2" (2.69m x 1.88m)  
Range of base and eye-level white gloss fronted units with complementary wood effect worktop and tiled splashback with stainless steel sink unit with mixer tap. Integrated electric oven and grill with a ceramic induction hob with hooded ventilation unit above. Space and plumbing for a washing machine, space for an upright fridge/freezer and a double-glazed window.

#### Bedroom

9'8" x 8'11" (2.95m x 2.72m )  
Electric panel heater and double-glazed windows overlooking the rear aspect.





### Modern Bathroom

Recently modernised matching white suite comprising low-level WC, wash hand basin with chrome mixer tap, and white gloss-fronted storage cupboard below. Panel bath with electric shower attachment and glazed shower screen. Wall-mounted mirror, four spotlights and extractor fan to the ceiling.

### Outside

Allocated parking space.

### Tenure

The property is Leasehold with vacant possession upon completion of the purchase. There are circa 94 years remaining in the lease. The service charge is currently £900.00 per annum with a ground rent of £150.00 per annum. The above details are for information purposes only and must be verified by a Solicitor.

### Services

All mains services are understood to be connected, with the exception of gas. NB We have not tested the heating, domestic hot water

system, kitchen appliances or other services and whilst believing them to be in satisfactory working order, we cannot give warranties in these respects. Interested parties are invited to make their own inquiries.

### Council Tax

The property is in Council Tax Band "B" - Warwick District Council

### Postcode

CV34 4UX

## Second Floor

Approx. 38.1 sq. metres (410.0 sq. feet)

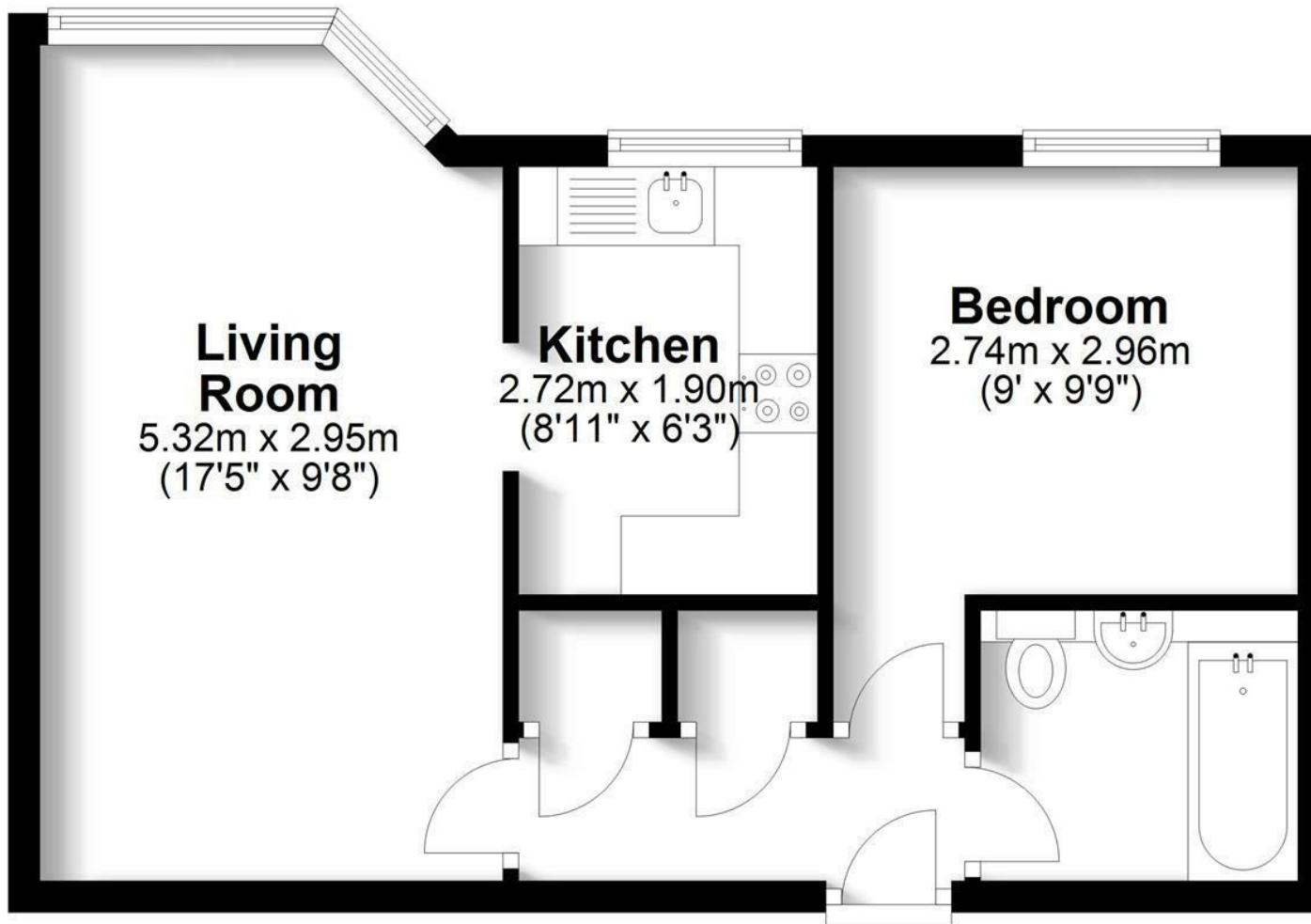

Total area: approx. 38.1 sq. metres (410.0 sq. feet)

This plan is for illustration purposes only and should not be relied upon as a statement of fact

Your Property - Our Business

- Residential Estate Agents •
- Lettings and Property Managers •
- Land and New Homes Agents •

Warwick Office  
17-19 Jury Street  
Warwick  
CV34 4EL

☎ 01926 499540 🌐 ehbresidential.com

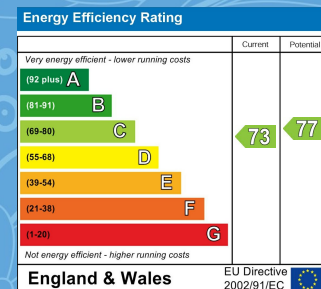

Also at: Leamington Spa, Somerset House,  
Clarendon Place, Royal Leamington Spa CV32 5QN

**IMPORTANT NOTICE** ehB Residential for themselves and for the Vendors of this property, whose agents they are, give notice that:- 1. The particulars are intended to give a fair and substantially correct overall description for the guidance of intending purchasers and do not constitute part of an offer or contract. Prospective purchasers and lessees ought to seek their own professional advice. 2. All descriptions, dimensions, areas, reference to condition and necessary permissions for use and occupation and other details are given in good faith, and are believed to be correct, but any intending purchasers should not rely on them as statements or representations of fact, but must satisfy themselves by inspection or otherwise as to the correctness of each of them. 3. No person in the employment of ehB Residential has any authority to make or give any representations or warranty whatever in relation to this property on behalf of ehB Residential, nor enter into any contract on behalf of the Vendor. 4. No responsibility can be accepted for any expenses incurred by intending purchasers in inspecting properties which have been sold, let or withdrawn. Measurement and other information. All measurements are approximate. While we endeavour to make our sales particulars accurate and reliable, if there is any point which is of particular importance to you, please contact this office and we will be pleased to check the information for you, particularly if contemplating travelling some distance to view the properties. 5. The agents will require identity documentation and evidence of address before entering into any transaction under money laundering regulations 2007.